



CASAMBI



➤ FEATURES

1. REPEATER CASAMBI
2. Input: 5Vdc
3. Command: APP CASAMBI
4. Signal repeater
5. Extended temperature range
6. 100% Functional Test – 5 Year Warranty



➤ PRODUCT CODE

CODE	Input voltage	Input command	Outgoing command	
CBU-REPEATER-USB	5Vdc	APP CASAMBI	REPEATER	REPEATER

Address management (DALI Variant) or Channels (DMX Variant) depends on the configuration of the Casambi module.

➤ TECHNICAL SPECIFICATIONS

	CBU REPEATER USB
Supply voltage	5 Vdc
Voltage Range	2 – 5.5 Vdc
Nominal Power	0,125W max
Storage temperature	min: -40 max: +60 °C
Ambient temperature	min: -25 max: +60 °C
IP Protection grade	IP20
Mechanical dimensions	10x 71.3x 24.3mm
Casing material	Plastic
Weight	15g

➤ MECHANICAL DIMENSIONS

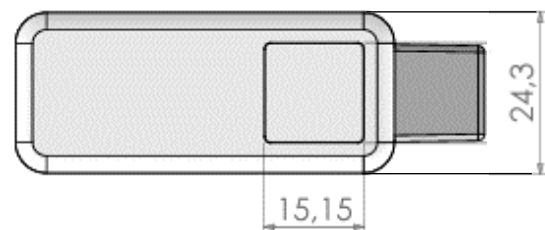
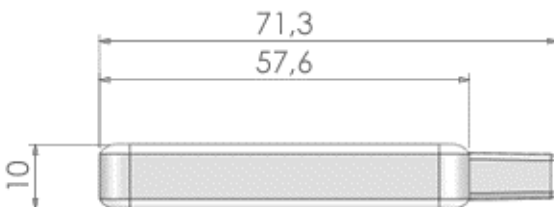

➤ SETUP CBU-REPEATER-USB CASAMBI REPEATER

Features:

The CBU-REPEATER-USB is a Casambi Bluetooth mesh repeater.
The device receives a Bluetooth signal, regenerates it and repeats it.

Led status:

The LED status is fixed to indicate that the power supply is properly connected to the device.

TYPE OF PROFILES

Type	# Profile	Name of Profile	Description
REPEATER	9948	REPEATER	The device acts as a Casambi signal repeater.

➤ INSTALLATION



Can be used with a plug power supply or via PC USB output



➤ UNPAIR DEVICE FROM THE CASAMBI NETWORK

If the device is associated with a network to which you do not have the credentials and you want to associate it with a new one, follow the settings specified in the Casambi APP in the "Nearby Devices" section. Once you have selected the unpair function and started the procedure, turn off the main power of the power supply connected to the CBU-REPEATER-USB and turn it on again after 1 - 2 seconds.

If the main power supply is switched off and on again quickly, unpair may not be done properly. Repeat the unpair sequence by allowing 1 or 2 more seconds to elapse between the moment you turn off and re-turn on the main power of the power supply¹.

¹ The discharge time of the power supply secondary depends on the construction characteristics of the power supply used.



➤ TECHNICAL NOTES

Installation:

- Isolate mains power before installing or adjusting switches. Maintenance must be carried out in the absence of AC voltage.
- Installation and maintenance must be carried out only by qualified personnel in compliance with current regulations.
- The product must be installed inside an electrical cabinet protected against power surges.
- External power supply must be protected. The product must be protected by fuses and / or circuit breakers with properly sized overcurrent protection
- Use in thermally hazardous environments may limit the output power.
- If required, the product must be properly dissipated
- Keep 5V (LV) circuits and non-SELV circuits separate from ultra-low safety voltage (SELV) circuits and all connections in this product. It is absolutely forbidden to connect for any reason, directly or indirectly, the 5V mains voltage to parts of the SELV circuit.
- To ensure the best performance and the latest functions made available by Casambi, make sure you have installed the latest version of the Casambi APP on your device.
- If the Casambi APP requires it, upgrade the FW version of the installed device. This guarantees the latest features and the available news.
- To guarantee the end user the best performance and correct operation, functional testing is carried out on 100% of the devices. If the device has remained associated with the Dalcnet test network, please decouple the device by following the information provided in the Casambi APP and in the paragraph "[UNPAIR THE DEVICE FROM THE CASAMBI NETWORK](#)".

WARNING:

For optimal functionality of the Casambi signal, do not put the device into metal or aluminium boxes and do not shield the device. As any other Casambi product, should not be placed in a metal enclosure or next to large metal structures. Metal will effectively block all radio signals which are crucial to the operation of the product.